

# Fire Ed 1 (Stage 1)

## Teacher Resource Kit



NSW RURAL  
FIRE SERVICE



# FIRE ED 1 PRE AND POST TEST

---

This activity must be completed three times:

- One week before commencing the program
- Immediately after completing the program; and
- Two months after completing the program.

## PART 1: 10 MINUTES

### Fire Safety Worksheet

Print out the Fire Safety Worksheet below and give one to each student. Ask students to complete the worksheet individually.

Stop the activity after 10 minutes.

Record the following results in the Fire Ed 1 Pre and Post Test Form:

- Number of students who completed each question correctly; and
- Average score of the class.

## PART 2: 2 MINUTES

### Fire Safety Cards

Print out the Fire Safety Cards below: one set for each student. Place one set of cards in a pile facing down in front of each student.

Tell the students to pretend that their house is on fire and they need to escape. Ask them to sequence the cards in the correct order to escape their house safely, from the action that should be carried out first, to the action that should be carried out last. Tell the students that they only have 2 minutes to sequence the cards to escape their house.

Stop the activity after 2 minutes.

The task is only correct if all 8 cards are positioned in the correct order.

Record the following results in the Fire Ed 1 Pre and Post Test Form:

- Number of students who completed the task correctly.

## FIRE ED 1 PRE AND POST TEST FORM

[www.fire.nsw.gov.au/forms/fire-ed-1-test](http://www.fire.nsw.gov.au/forms/fire-ed-1-test)

## PART 1 (10 MINUTES): FIRE SAFETY WORKSHEET

Name: \_\_\_\_\_

Date: \_\_\_\_\_

1. Circle the ZERO and the EMERGENCY BUTTON on the Mobile Phone.

/2

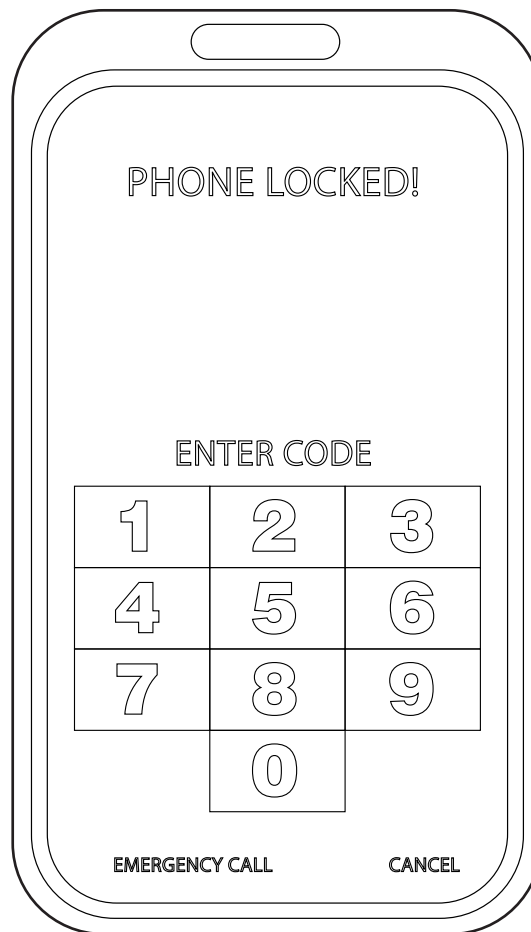

2. Circle the TOOLS for adults.

/3



3. Circle the action you should take when your clothes catch on fire.

/1

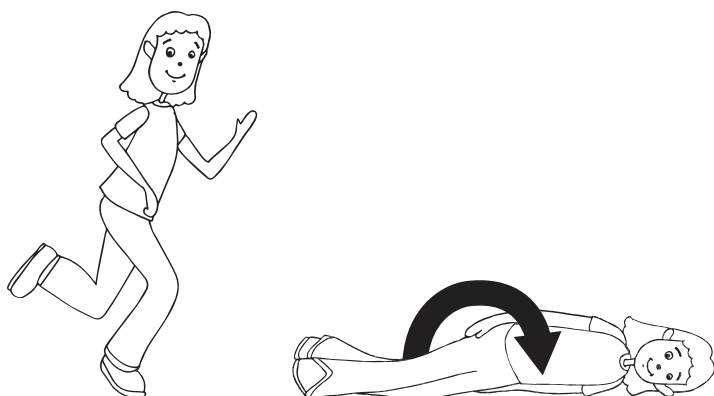

4. Circle all the things that are UNSAFE in the picture below.

/8



Source: AFAC Li'l Larikkins Bushfire Safety

Your score:

/14

**PART 2 (2 MINUTES): FIRE SAFETY CARDS**

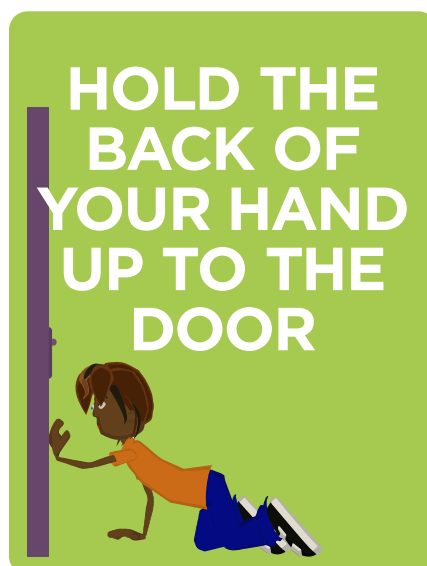
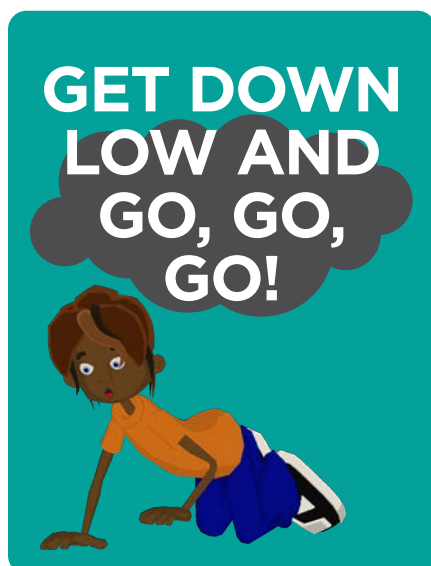
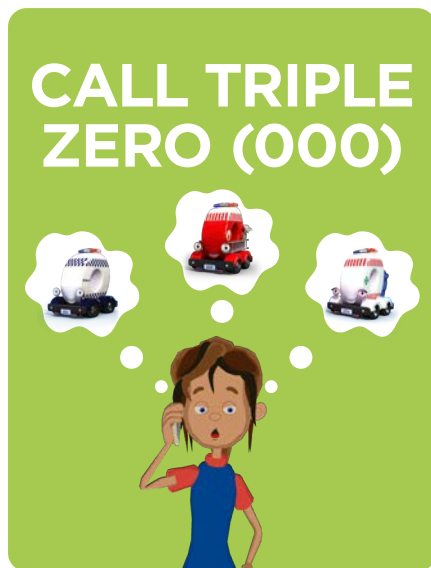



## PRE AND POST TEST ANSWERS

### Fire Safety Worksheet

1. Circle the 'O' and the 'emergency call' buttons.
2. Circle the lighter, knife, and box of matches.
3. Circle option three: 'Stop, Drop, Cover, and Roll'.
4. Circle the 8 unsafe things, as displayed below.

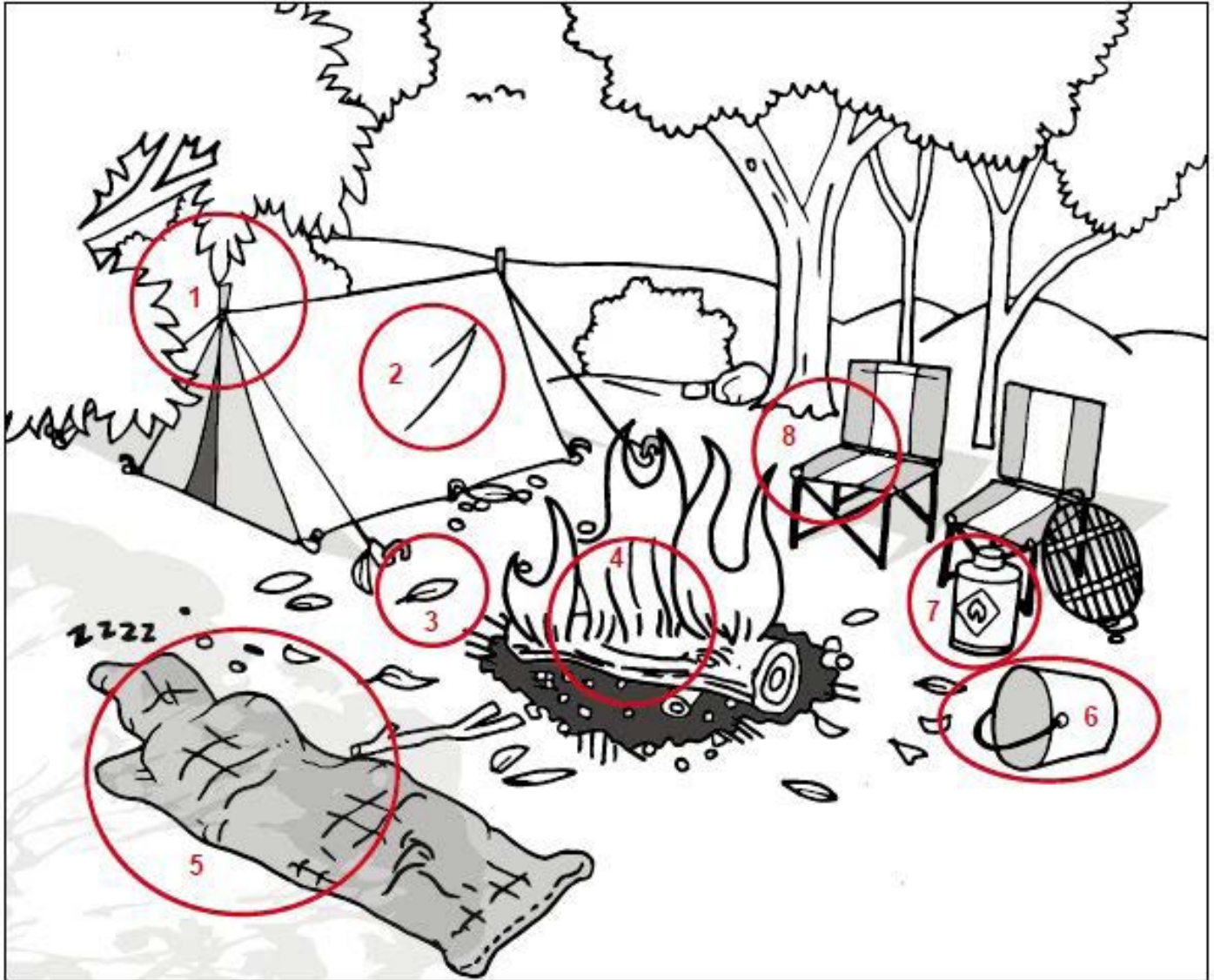

### Fire Safety Cards

All eight cards must be placed in the following order:

1. Get down low, and go, go, go
2. Shout 'FIRE, FIRE, FIRE'
3. Hold the back of your hand up to the door
4. Close doors behind you
5. Get out and stay out
6. Go to your safe meeting place
7. Call Triple Zero (000)
8. Wait for Firefighters

# LESSON ONE

---

## HOME FIRE ESCAPE DRILL FLASH CARDS

**GET DOWN  
LOW AND  
GO, GO,  
GO!**





**SHOUT  
“FIRE, FIRE,  
FIRE!”**

**FIRE, FIRE,  
FIRE!**

**HOLD THE  
BACK OF  
YOUR HAND  
UP TO THE  
DOOR**



# CLOSE DOORS BEHIND YOU

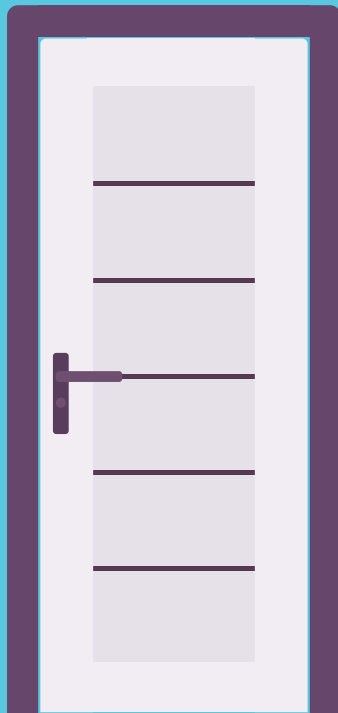

# GET OUT AND STAY OUT



# GO TO YOUR SAFE MEETING PLACE



# CALL TRIPLE ZERO (000)





# WAIT FOR FIREFIGHTERS



## HOME FIRE ESCAPE DRILL FLOW CHART



# LESSON TWO

## MOBILE PHONE

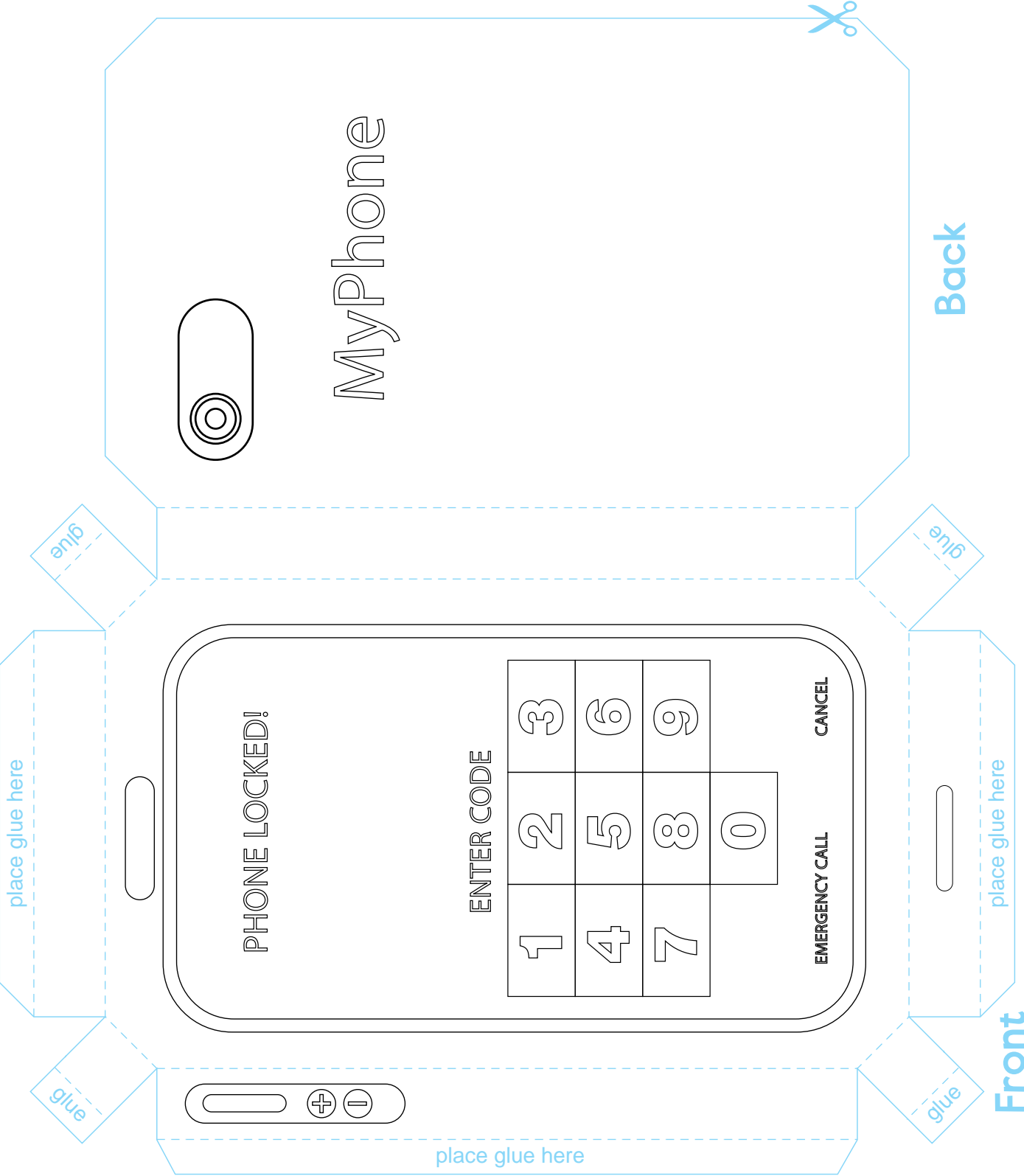

# LESSON THREE

---

## IDENTIFY THE HAZARDS AND MAKE THEM SAFE - FIRE HAZARD CARDS













**STOP, DROP, COVER, AND ROLL FLASHCARDS**

# STOP



# DROP



# COVER



# ROLL



## BURN FIRST AID FLASHCARDS

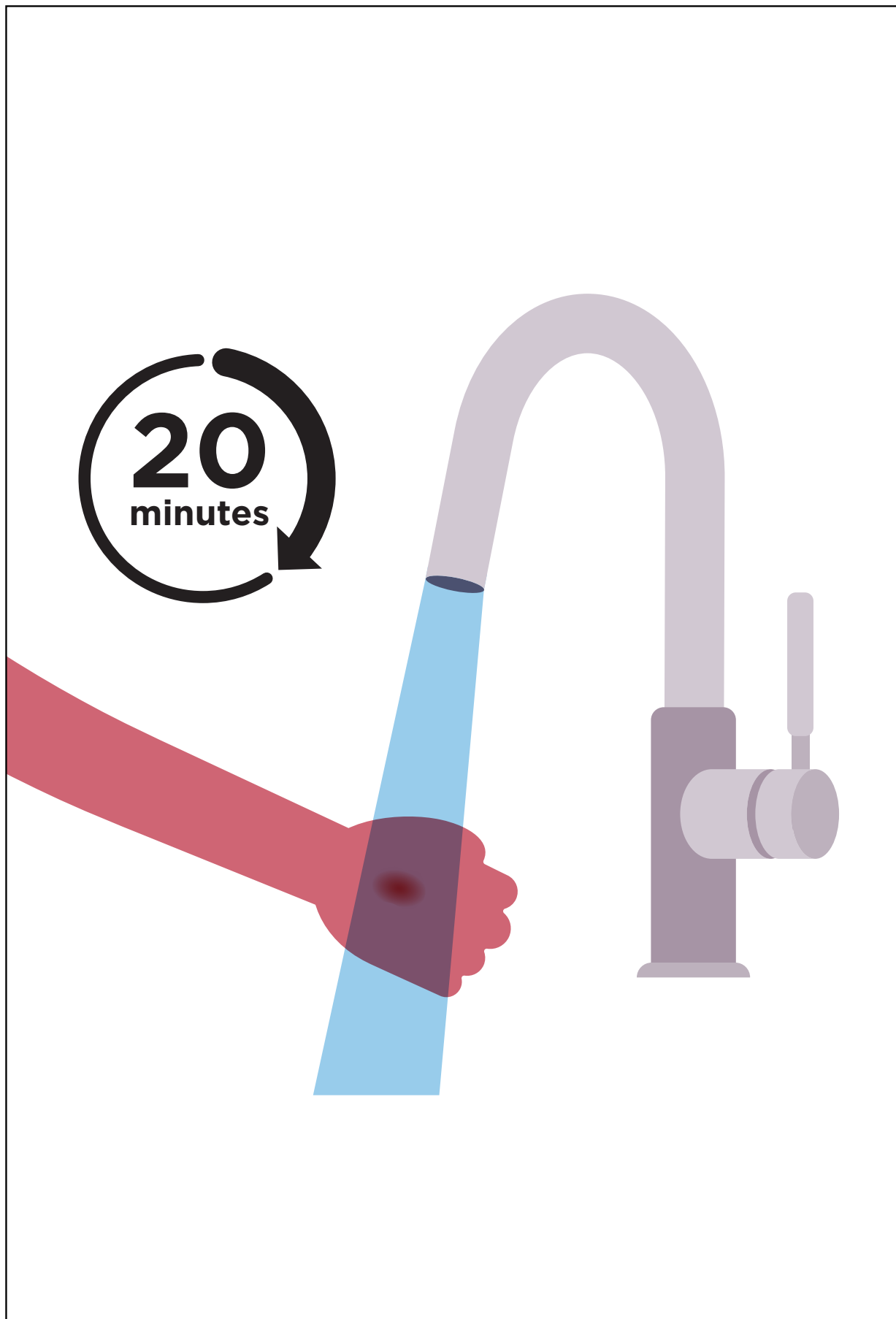



For a burn that is smaller than a 20-cent piece, place the burn under cool running water for 20 minutes. Wrap in a clean, wet bandage and see a doctor.

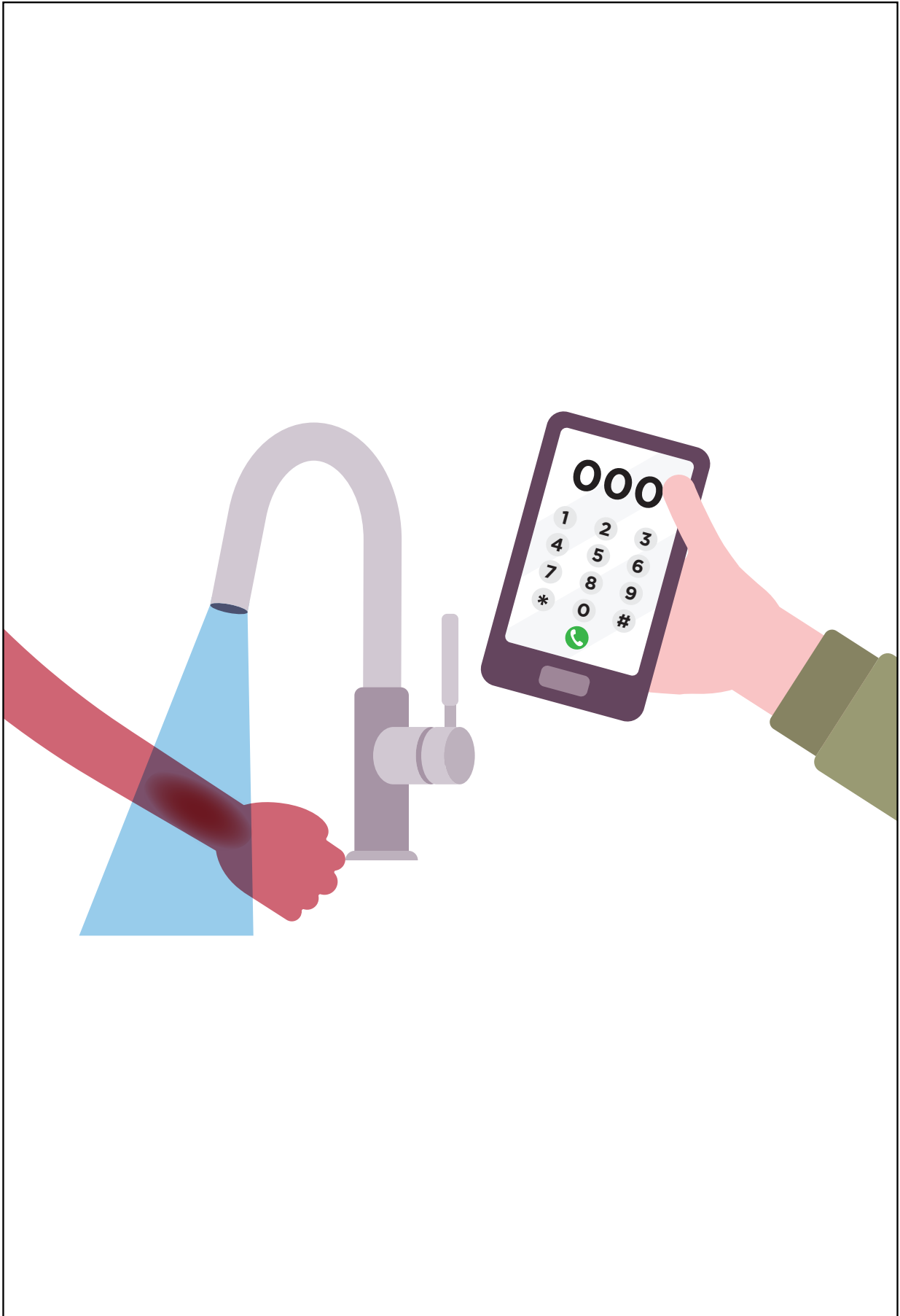

For a burn that is bigger than a 20-cent piece, place the burn under cool running water while you call Triple Zero (000) and follow the advice of the operator.

# LESSON FOUR

---

## PREPARING YOUR HOUSE FOR THE BUSHFIRE SEASON

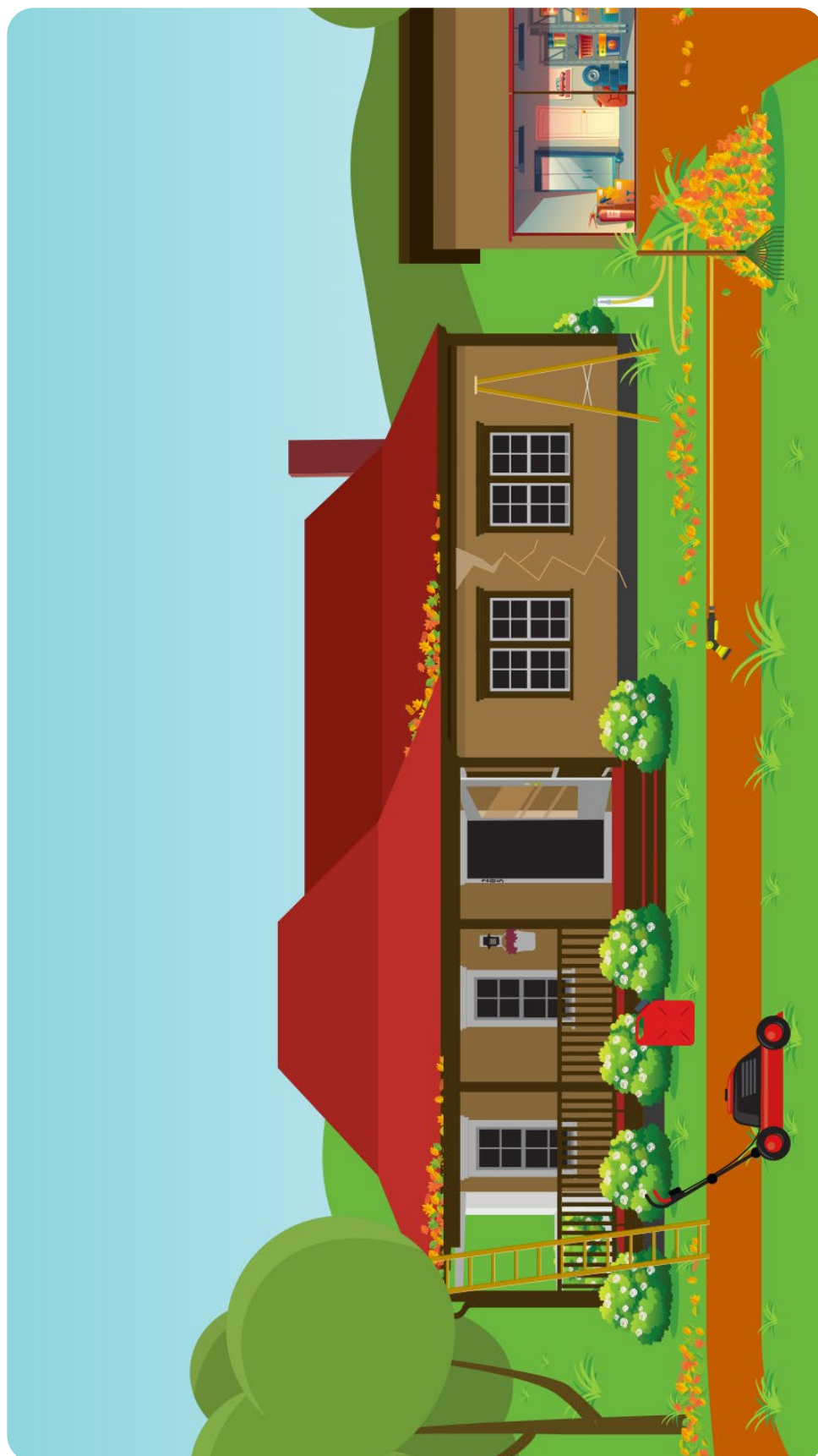

**Congratulations, you have completed Fire Ed 1!**

You are now a

**Triple Zero Hero**

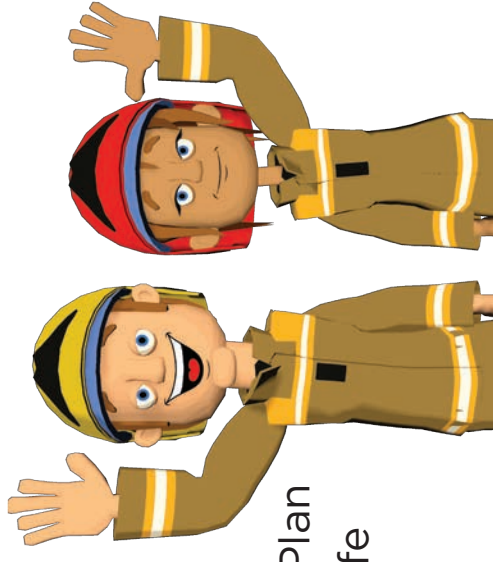
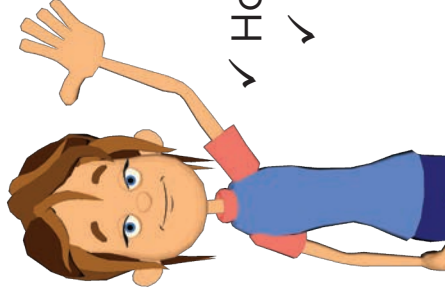
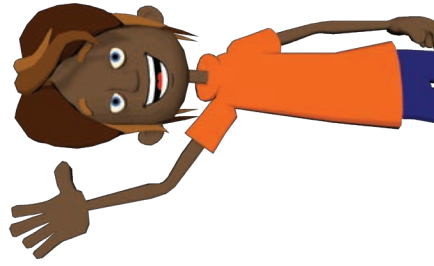

---

Now knows:

- ✓ How to stay safe if there is a fire
- ✓ How and when to call Triple Zero (000)
- ✓ How to create and practice a Home Fire Escape Plan
  - ✓ How to identify fire hazards and make them safe
  - ✓ About bushfires and campfires
  - ✓ About matches and lighter safety



# HOME FIRE ESCAPE PLAN

## ESCAPE PLAN

Draw a floor plan of your home, including two ways of escape from each room. Plan an escape route and ensure everyone knows how to get out. **Make sure you practice your escape plan.**

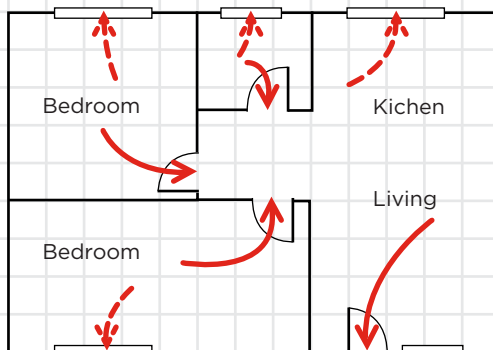

### KEY

- First escape route
- - - Second escape route

EXAMPLE



**GET OUT, STAY OUT AND  
CALL TRIPLE ZERO (000)**

Calls are free and can be made from mobile phones, home or work phones or pay phones.

For more information on home fire safety visit:

**[fire.nsw.gov.au](http://fire.nsw.gov.au)  
[rfs.nsw.gov.au](http://rfs.nsw.gov.au)**